

UPVC SCH40/80 PIPING SYSTEM

TUMPA NY

- UPVC SCH 40/80 直管 Pipe (5.8M/PCS)
(400 / 800)

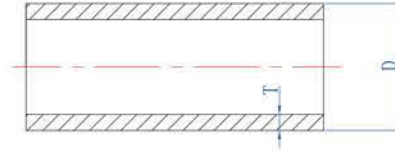

Nominal Size	Socket Type		Wall Thickness, Working Pressure (PSI)					
	D (mm)	Tolerance	SCH80			SCH40		
			T (mm)	Tolerance	PSI	T (mm)	Tolerance	PSI
1/2"	21.34	±0.10	3.73	+ 0.51	850	2.77	+ 0.51	600
3/4"	26.67	±0.10	3.91	+ 0.51	690	2.87	+ 0.51	480
1"	33.40	±0.13	4.55	+ 0.53	630	3.38	+ 0.51	450
1-1/4"	42.16	±0.13	4.85	+ 0.58	520	3.56	+ 0.51	370
1-1/2"	48.26	±0.15	5.08	+ 0.61	470	3.68	+ 0.51	330
2"	60.32	±0.15	5.54	+ 0.66	400	3.91	+ 0.51	280
2-1/2"	73.02	±0.18	7.01	+ 0.84	420	5.16	+ 0.61	300
3"	88.90	±0.20	7.62	+ 0.91	370	5.49	+ 0.66	260
4"	114.30	±0.23	8.56	+ 1.02	320	6.02	+ 0.71	220
5"	141.30	±0.25	9.52	+ 1.14	290	6.55	+ 0.79	190
6"	168.28	±0.28	10.97	+ 1.32	280	7.11	+ 0.86	180
8"	219.08	±0.38	12.70	+ 1.52	250	8.18	+ 0.99	160
10"	273.05	±0.38	15.06	+ 1.80	230	9.27	+ 1.12	140
12"	323.85	±0.38	17.45	+ 2.08	230	10.31	+ 1.24	130

Standard Lengths: 19ft (5.8M)

Standard Colors: Dark Grey

Remark:

$1\text{kg/cm}^2 = 14.223\text{ PSI}$ $1\text{Mpa} = 142.86\text{ PSI}$ $73^\circ\text{F} = 22.8^\circ\text{C}$

以上壓力適用於水溫 $73^\circ\text{F}(23^\circ\text{C})$ ，當溫度高於 $73^\circ\text{F}(23^\circ\text{C})$ 時，
須視材料(UPVC 或 CPVC)參考溫度遞減常數